

# 270° EMITTING SILICONE LED FLEX NEON

Model: SE120JC3-025

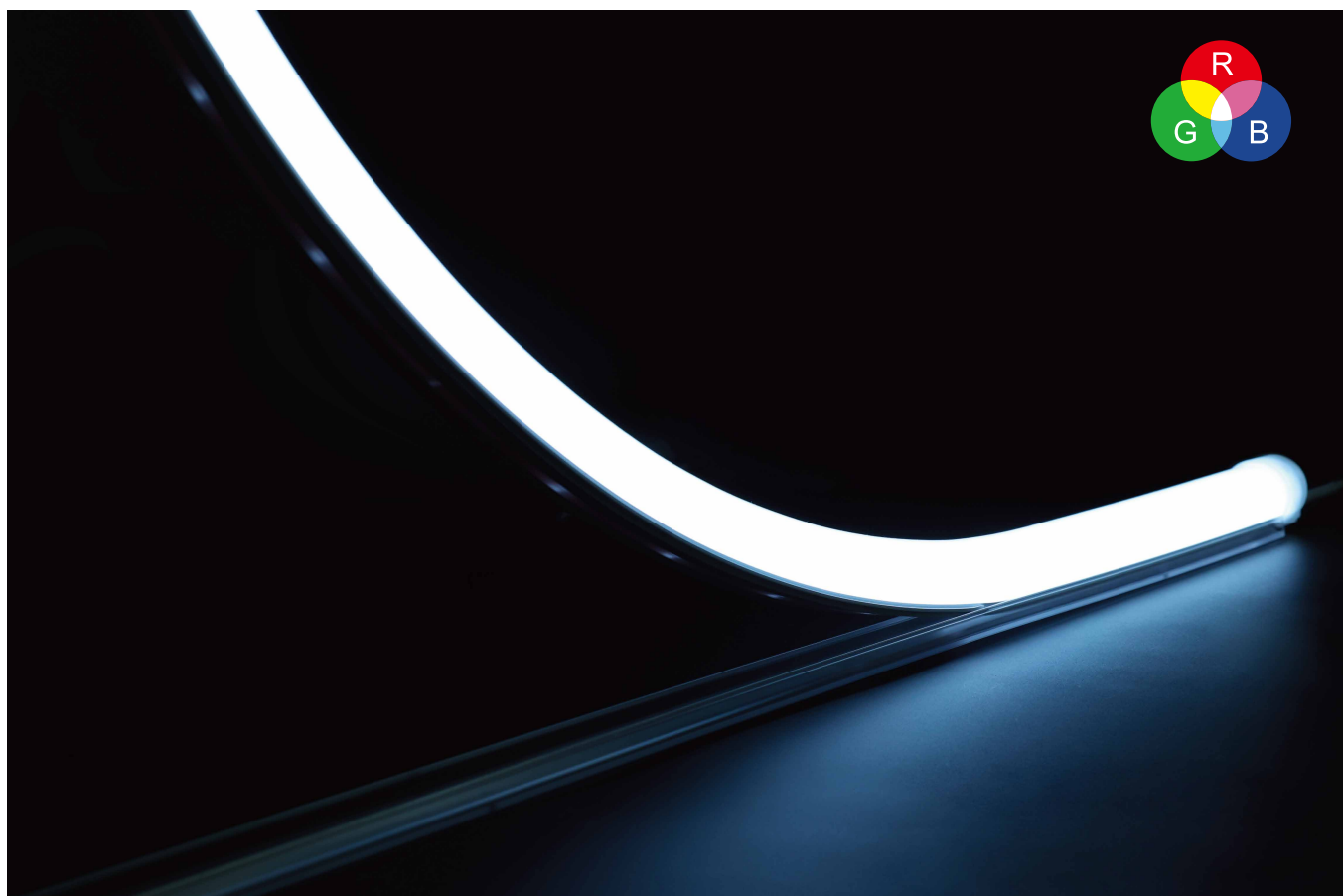

## Features

- 1) Transparent mouting fixtures provided which is invisible from top view.
- 2) Unique optical distribution design, light emits evenly with high brightness.
- 3) Arc-shaped light-emitting surface, light-emitting angle 270°.
- 4) Environmentally friendly silicone material, good flexibility with simple appearance.
- 5) IP65 protection level, acid, alkali, salt corrosion resistance, UV resistance.
- 6) ERP spectroscopic standard, single bin supply, good color consistency.
- 7) CE, RoHS, UL, TUV, BIS, CB and LM-80 certified.
- 8) 3 years warranty.

## Application

Home decorative lighting, landscape lighting, city lighting, the places that need linear lighting effect etc.

## Parameters

Part Number	SE120JC3-025	CRI	Color	CCT(K)	Beaming Angle	Luminous Flux (LM/M)	Efficacy (LM/W)
Dimensions	5000*25*27.2mm		WW	2700	≥270°	625	65
LED Type	/		WW	3000	≥270°	670	70
LED Qty/m	120LEDs/m	80+	NW	4000	≥270°	815	85
Voltage	DC24V		MW	5000	≥270°	765	80
Input Current (A)	0.4A (1m)		W	6500	≥270°	720	75
Power	9.6W/M	<b>Remarks:</b>					
Power Range	8.6~10.6W	1) The given data are typical values due to the tolerance of the production and electrical components, output value and electrical power can vary up to 10%.					
Times of Power On and Off	>10000 Times	2) Testing standards refer to IES LM-79-08.					
IP Grade	IP65	3) The above luminous flux is based on CRI80, and the number will reduce by around 20% in CRI 90.					

## Dimension

Unit: mm/inch

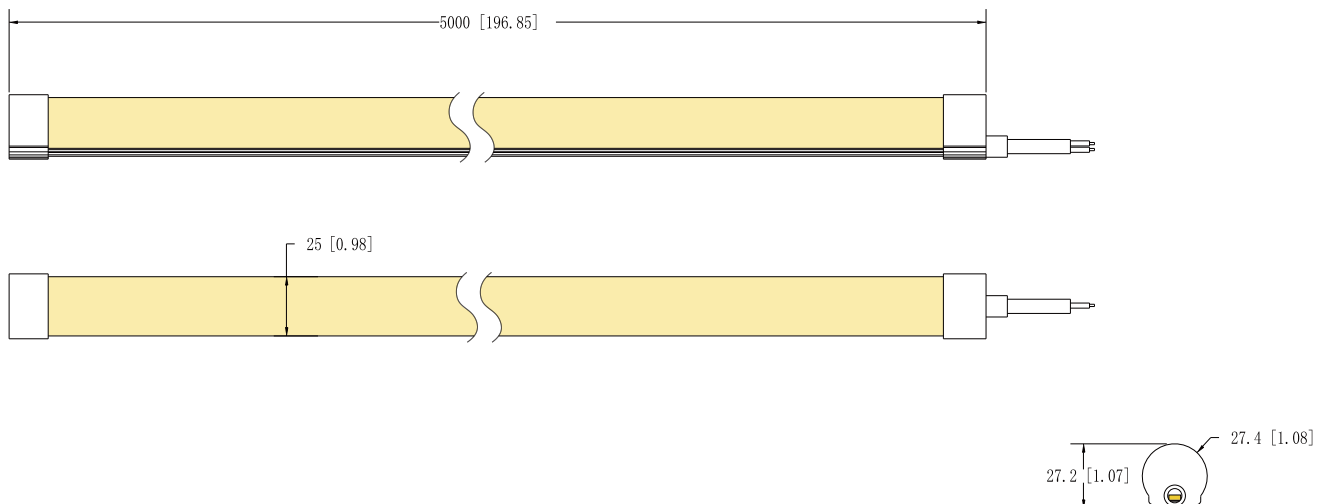

## Rendering Index Comparison

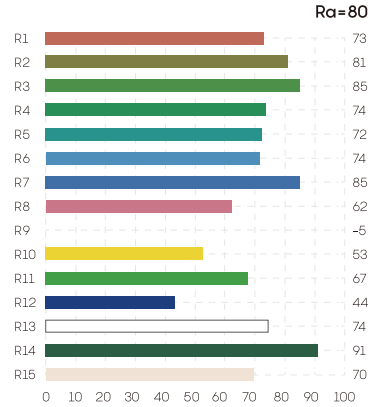
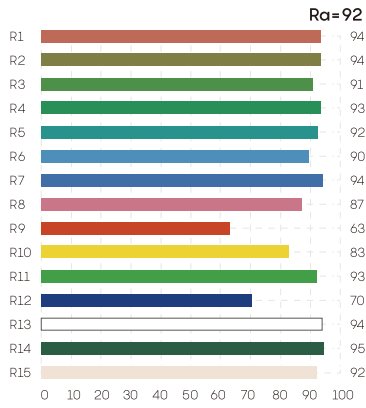

## Provide Full CCT Range From 2700K to 6500K

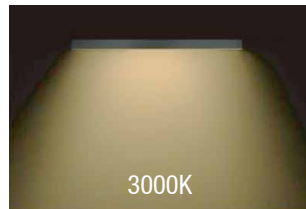
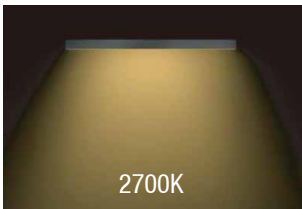

## Beaming Angle

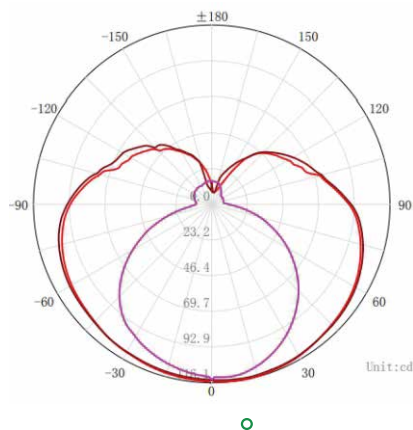

## Wire Connection

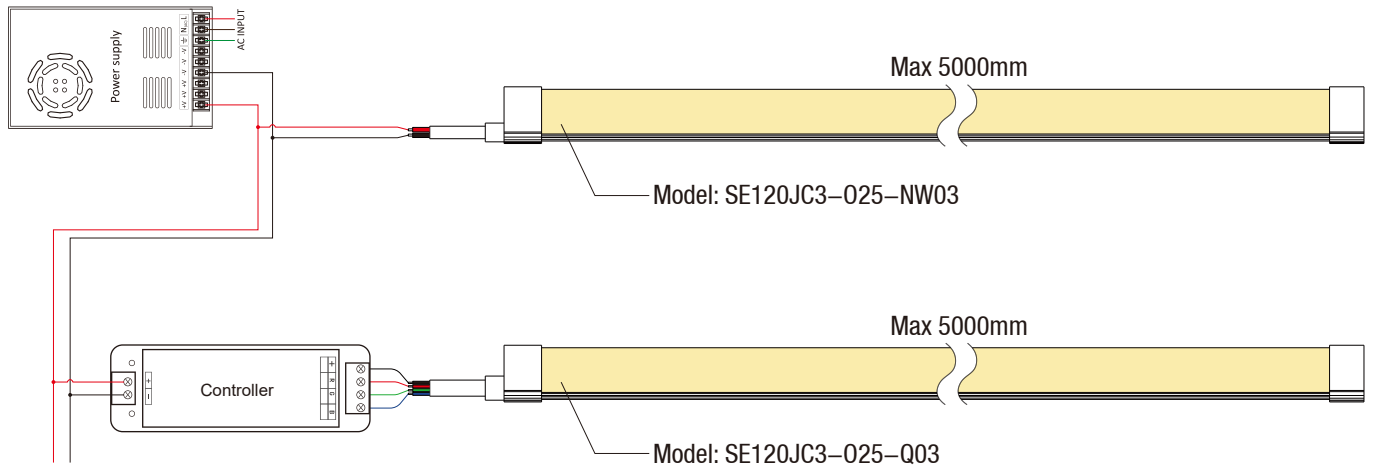

## Mounting Accessories

Part Number	4221469-001	4221469-002	4260499-003
Name	Aluminum channel	Aluminum channel	PC Transparent snap
Dimension(mm)	22*9*960	22*14*960	26*10*960
Drawing			

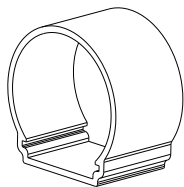

Tail Plug

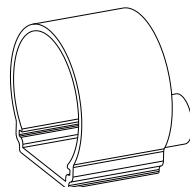

Straight out line

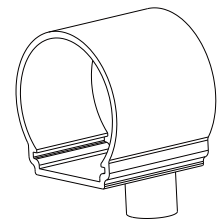

Bottom out

## Bending Direction

Please note when installing the strip, not all directions can be bent, bending shape, bending diameter size and direction, please follow the legend below to avoid damage to the LED strip.

### Correct Bend

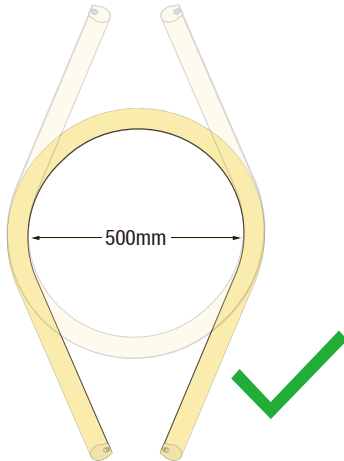

The front side of the luminous surface, bent in half, with a minimum diameter of 500mm

- This product adopts low-voltage DC power supply and must be used with AC-DC switching power supply after voltage conversion. It is strictly forbidden to connect the LED strip directly to AC110V or AC220V utility voltage, otherwise it will damage the LED strip and may cause safety accidents.
- Please read the product specification carefully before using this product, and also ask the professional to install it to ensure safe use.

### Wrong Bend

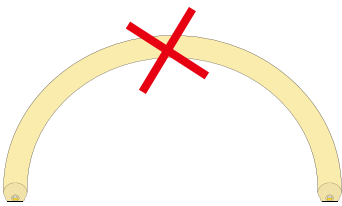

Please do not bend the side of the luminous surface to avoid damage.

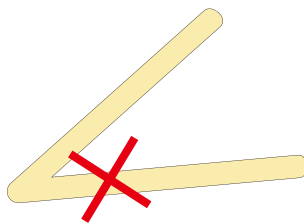

Small Angle bending is prohibited.

- The PCB inside the casing is front mounted and can only be bent up and down.

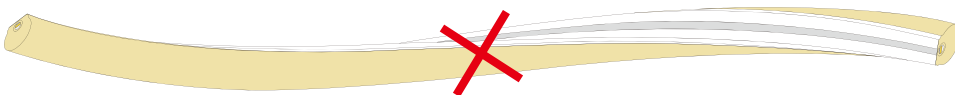

Please do not twist the LED strip to avoid damage.

## Installation Method

### Shear Mounting

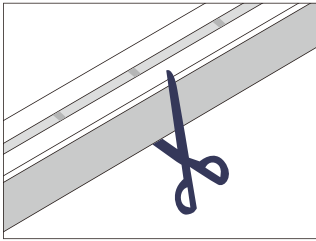

Cut at the location of the black dot mark at the bottom of the LED strip.

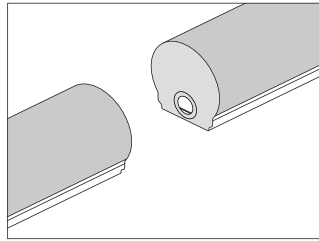

Shearing flat.

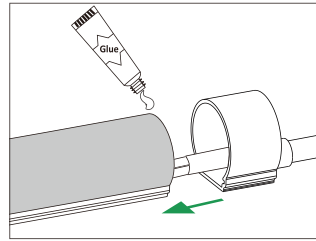

Apply glue to the end of the sleeve and install the plug in the direction of the arrow.

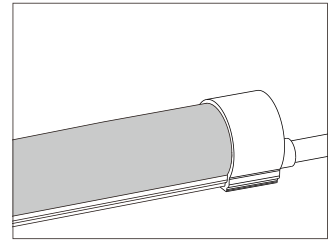

Install the plug and leave it for 2–3 hours before moving, 12 hours before the next step.

### Snap Installation

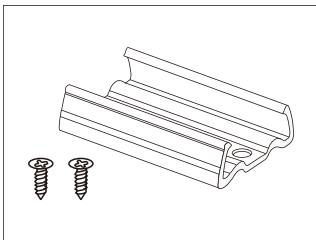

Prepare the screws and fixing clips.

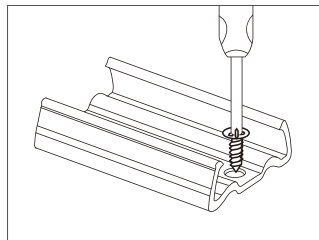

Adjust the fixing clips to the right position and use a screwdriver to drive in the screws for fixing.

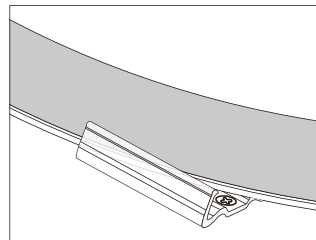

Turn the luminous side of the light body upward and gently force the LED strip into the fixed clasp.

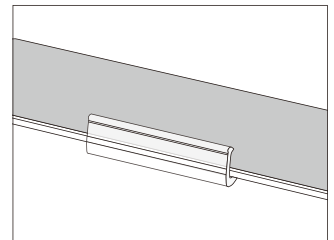

Installation is complete.

## Packing Information

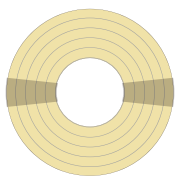

5 meters per roll

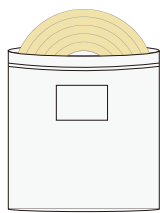

One roll per antistatic bag

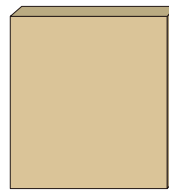

1 Bag per inner box

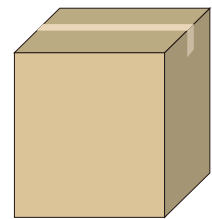

4 Box per carton

Part Number	Outer Box Dimension (mm)	Inner Box Dimension (mm)	Quantity Per Carton (m)	Net Weight (kg)	Gross Weight (kg)
SE120JC3-025	L550*W550*H260	L535*W535*H58	20	8.8	9.6

Given the packing manner difference, the actual packing information is subject to that for the real products.

## Instructions

- 01) Disassembling or modifying the product is not allowed.
- 02) Installation with power on is not allowed.
- 03) Any organic solvent chemical is not allowed.
- 04) Isolation and corrosion prevention on all wiring points and wire ends.
- 05) Make sure the power wire is big enough and ensure the voltage and connection are all correct before power on.
- 06) Installation, maintenance should be done by professional staff.
- 07) The power wire between power supply and LED strips should be less than two meters to keep the same brightness on all parts.
- 08) Do not power on during installation or assembly of the light strip, to avoid short-circuiting and burning out of the light strip due to misoperation during the operation
- 09) The lamp beads can only be powered on when they are connected, installed and correct.
- 10) When installing, try to avoid excessive bending and twisting of the light strip, so as not to damage the conductive components and cause defects.
- 11) The LED flexible light strip can only be cut at the place where the cut mark is printed on the light strip. Cutting at other places will damage the circuit circuit of the light strip and cause some lamp beads to not light up.
- 12) The minimum bending diameter of this product: 500mm.

## Declaration

- 01) To ensure the safety, the broken wires need to be replaced by the manufacturer or the service agent, or by the qualified staff.
- 02) The given data in the specification is the laboratory data, there may be discrepancy found in the actual products.
- 03) The given drawings in the specification are only for reference, there may be discrepancy found in the actual products.
- 04) The products are subject to change without prior notification.



Official Website



WeChat Public

## SHENZHEN LEADBEYOND LINEAR LIGHTING CO., LTD.

Tel: +86-755-83056231    info@leadbeyondled.com    www.leadbeyondled.net    www.leadbeyondled.com

Company Address.: 28F, Luban Building, Hongli West Road, Futian District, Shenzhen 518034, China

Factory Address: 3F, 4F and 6F, Buiding A&B Xinyongfeng Industrial Area, Yingrenshi Village, Shiyan Town, Bao'an District, Shenzhen 518108, China